

INSTALLATION & USER MANUAL

DAYLIGHT SLIDING DOORS

Delivered from March 2023 to week 48 in 2024



Click on the content to go
directly to the relevant section

Sill requirement	3
Crane and/or unpacking of element	3
Shimming of threshold	4
Shimming of side frames and hidden fastening	5
Separation of frame and sash	6
Adjustment of Softclose	6
Maintenance	6
Operation	6

Daylight sliding doors

Delivered from March 2023 to week 48 in 2024



Sill requirement: 200 mm

A Daylight sliding door has a frame depth of 184 mm. The exterior part of the threshold is made of fibreglass. This provides excellent energy performance and long durability, but it is not strong enough to support the sliding door without full support. A sill of approx. 200 mm is required to properly support the door. See shimming of threshold.

Crane and/or unpacking of element

Follow this guide to avoid damaging the sliding door during unpacking and removal from the pallet.

1. The threshold of the sliding door is primarily made of fibreglass. This provides excellent energy performance and long durability, but it is not strong enough to support the sliding door without support.
If the element hangs over the edge of the pallet upon delivery, use the included "support block" to support the part of the sliding door hanging over the edge before attempting to open the door.
2. Remove the cover on the back side of the master sash (figure 1).
3. Remove the guide at the top on the rear edge of the master sash. It is not necessary to remove the bottom guide (figure 2).
4. Place suction cups on the glass of the master sash to prepare for lifting it off.
5. Prepare a place where the master sash can be temporarily placed while the frame is being installed. Use a couple of battens to place the sash on, and protect the sash from scratches. Protect the aluminium sash from bending.
6. Remove the track lock in the top frame aluminium part.
Warning: When the track lock is removed, the master sash may fall out – it is therefore important that one person holds the sash when the track lock is removed (figure 3).



Continued on the next page →

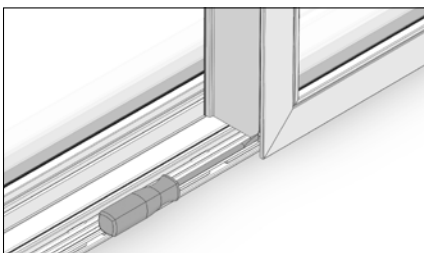

Figure 1: Cover removed from back side of master sash

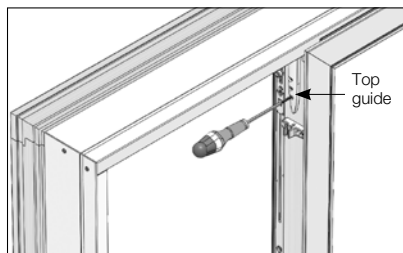

Figure 2: Guide removed at top

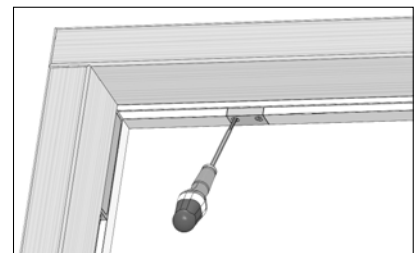

Figure 3: Track lock

7. Slide the sash to nearly closed position – locate the position where the guide at the top of the master sash can be led out through the hole where the track lock was.
8. The sash can now be released and set aside.
9. Move the suction cups to the glass in the fixed part of the frame to prepare for lifting from pallet to wall opening.
10. Release the frame from the pallet and support boards and move it to the wall opening.

Shimming of threshold

Plastic support blocks of appropriate size and spacing are mounted under the sliding door upon delivery. They are 10 mm high, so an additional 2 mm must be added under each block to achieve the recommended 12 mm joint under the door.

It is very important that the threshold is shimmed so that it is precisely level – both in the sliding direction and in the in/out direction. Be very meticulous with the shimming (figures 4).

The threshold must be level at each individual plastic block. Use the green 5 mm thick block to check if the threshold is level in the in/out direction. The bottom frame must also be shimmed at the outer ends under each side frame and directly under the track 16 mm from the front edge of the fibreglass threshold every 300 mm, so the bottom frame is level.

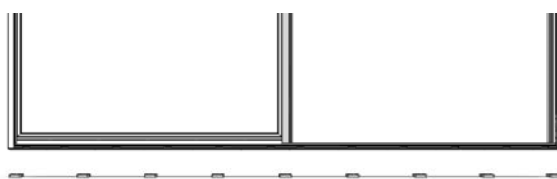

Figure 4: Illustration of threshold shimming

Important: It is very important that the threshold is shimmed with great care. Use the blocks that are pre-mounted under the sliding door. Shimming must be done under both side frames and mullion. There must be a maximum of 300 mm between each support block under the threshold. The threshold must be level in the door's sliding direction, but it is equally important that it is level in the in/out direction! Level in the in/out direction is checked using the supplied green 5 mm plastic block in combination with a spirit level, as illustrated in figures 7, 8, and 9.

Shimming of side frames and hidden fastening

The Daylight sliding door is, by nature, a very slim construction that provides maximum light and view. However, it is very demanding in terms of precise shimming and fastening. Be systematic and meticulous during installation.

1. Shimming of threshold as described above (figure 5).
2. Remove the aluminium cover at the fixed part. The sliding door is fastened by drilling through the aluminium frame externally behind the cover, keeping the mounting screws hidden (figures 6 and 7).
3. Remove the striking plate on the lock side and fasten the aluminium frame behind it so the fastening remains hidden.
4. Complete the installation of the side frames before fastening the top and bottom. Be very careful that the side frames are vertically aligned in both directions – this is crucial for the door to slide and close properly.
5. Mount the master sash to check the frame installation before covers and striking plates are mounted. Install the track lock to ensure the sash cannot fall out. Reinstall the guide on the back side of the master sash.
6. Do not attempt to force the door closed if there is high resistance. High resistance is caused by the guide not aligning with the hole in the bottom or top track. Adjust the frame in the wall opening instead – side frames must be 100% vertical.
7. Mount screws in the top aluminium frame at the two screw slots with a maximum spacing of 900 mm between each screw.
8. The aluminium tread is prepared for installation with double-sided tape. Remove the tread and place screws for fastening the threshold underneath on the dry side. The first screw is placed close to the mullion, and then with a maximum spacing of 900 mm on the master side. The fixed side of the bottom frame is not fastened.
9. Wait to install the tread until the door is fully installed and operating correctly. The double-sided tape used to fasten the tread is very strong, and once the tread is mounted, it is easily damaged if removed again. Be very careful when mounting the tread – hold the front edge against the wooden strip underneath to ensure correct alignment on the first attempt.
10. Side and top frames are fastened every 900 mm. Side frames are shimmed behind fastening points. Side frames must be shimmed behind striking plates as protection against burglary.
11. Ensure there is a minimum 10 mm joint around the frame in the wall opening for alignment, shimming, and sealing. If the wall opening is very uneven, 10 mm may not be sufficient for alignment. No solid base must be used at fastening points in the top frame, and mortar must not be used for sealing. Once the frame is correctly positioned, remove the cover strips on the sides and drill holes in the aluminium frame for frame screws.

Important for Daylight sliding doors: Support under the running track and under the fixed section.

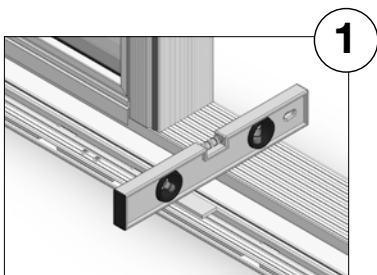

Figure 5: Check level in in/out direction using the supplied green 5 mm plastic blocks and a spirit level

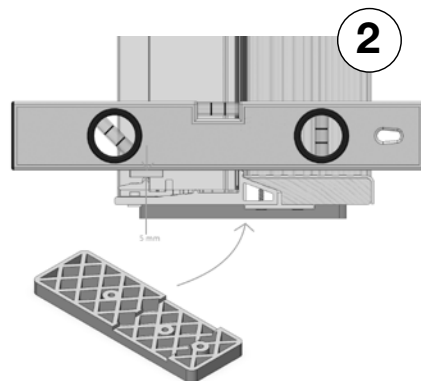

Figure 6: Check level in in/out direction using the supplied green 5 mm plastic blocks and a spirit level

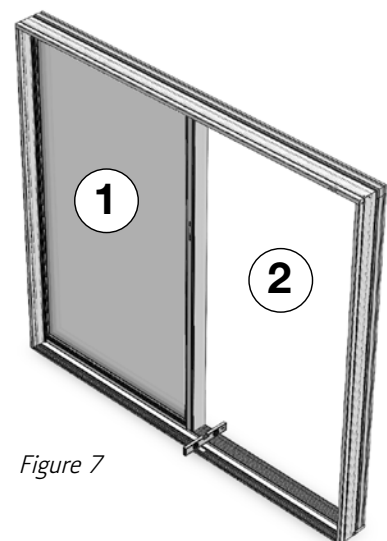

Figure 7

REMEMBER:

For Daylight products, sealing must only be done to the rebate, as the aluminium part is part of the openable sash.

Separation of frame and sash

First, remove the aluminium cover from the rear edge of the master sash.

Then open the door until the track lock becomes visible in the top frame. The track lock is secured with two screws (figure 8 and 9).

Slide the sash to the position where the track lock was, and it can now be tilted out from the top and lifted away.

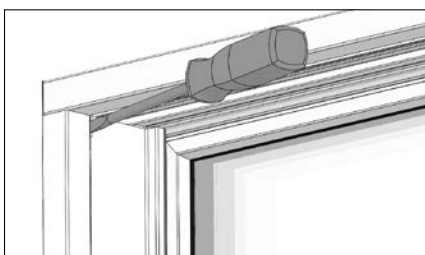

Figure 8: Aluminium cover removed for drilling into frame for screws

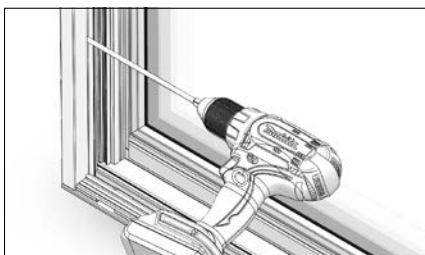

Figure 9

Adjustment of Softclose

The Daylight sliding door is equipped with Softclose mechanisms at both ends. One mechanism catches the master sash when closing, and the other catches it when opening.

The Softclose catch can be adjusted both vertically and in terms of the position where it stops the sash.

Vertical adjustment ensures the catch just clears the master sash. Forward/backward adjustment in the track ensures the sash stops in the correct position – one catch for closed, another for open.

Note: The first time the sash is operated, the Softclose mechanisms may be inactive. Carefully move the sash to the closed and open positions to activate the Softclose. You will hear a click when they engage. After that, they are active.

Maintenance

The openable sash runs on the exterior side. It is therefore important to clean the track of dirt, leaves, etc. The espagnolette should be lubricated 1 to 2 times a year to ensure smooth operation.

Operation

Daylight sliding doors are operated by turning the handle 90° upwards, allowing the door to slide out and be moved sideways.

WE MAKE IT EASY TO CHOOSE, BECAUSE

- We provide a 10-year warranty
- Danish windows must be produced in Denmark
- Standard burglary protection is, of course, included in the price
- We are actively working to contribute to the green transition